

BARRISTER

EXECUTIVE SUITES, INC.

CENTURY PARK PLAZA

1801 Century Park East, 24th & 25th Floors

Los Angeles, CA 90067

(310) 552-0700/http://www.barrister-suites.com

800-576-0744

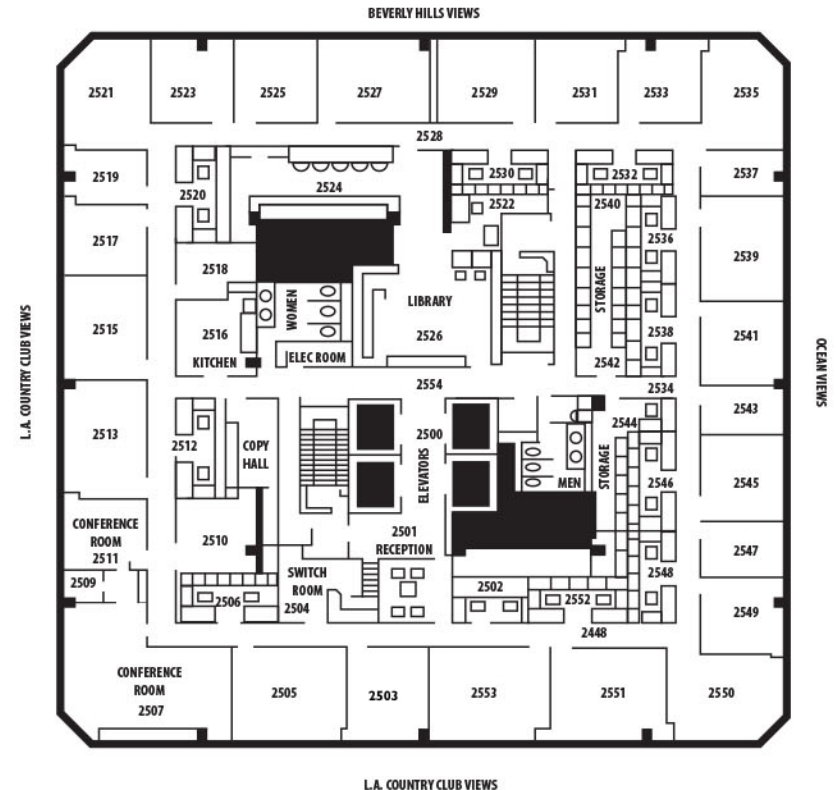
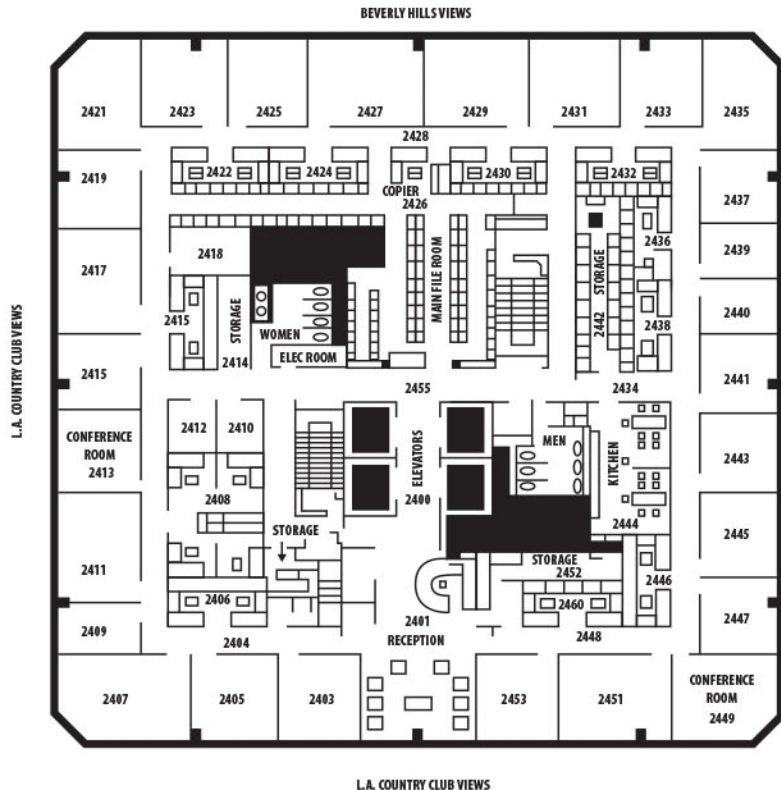
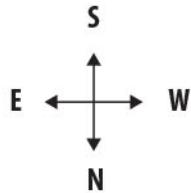

Suite Managers: Jacqueline Jansen
Hours of Operation: 8:30am to 5:30pm

DIRECTIONS: 405 Fwy to Santa Monica Blvd.
Corner of Little Santa Monica and Century Park East

PARKING: Unreserved: \$250.00
Reserved: \$350.00

AMENITIES: Views, High-Speed Internet Access, Voice Mail, Facsimile, Photocopiers, Postage, Five (5) Conference Rooms, Full Service Copy Center, Information Center on-site, Rental Furniture, Concierge

POINTS OF INTEREST: Shubert Theater, Food Court, Four Star Hotels, Theaters, Century City Shopping, Fine Dining