

BARRISTER

EXECUTIVE SUITES, INC.

SEARISE OFFICE TOWER

233 Wilshire Blvd., Suite 400

Santa Monica, CA 90401

(310) 917-1000/ www.barrister-suites.com

800-576-0744

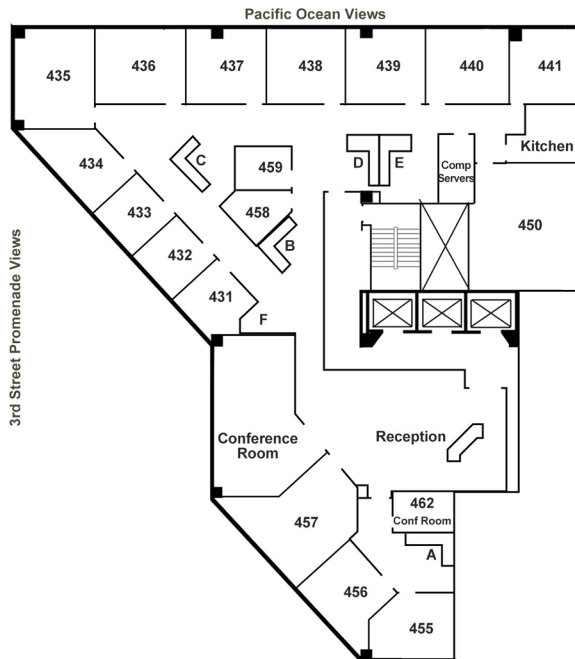
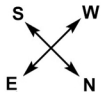

Area Manager: **Jacqui Jansen**

Hours of Operation: 8:30 am -5:00 pm

DIRECTIONS: Take either the 405 or 110 Freeway to the 10 Freeway West towards Santa Monica. Take 4th Street exit, turn right onto 4th Street, left onto Wilshire Blvd. Located on the northwest corner of 3rd Street and Wilshire.

PARKING: \$250 Reserved, \$150 Unreserved

AMENITIES: Breathtaking Views of Pacific Ocean and Santa Monica Mountains, 24 Hour Manned Security, Enterprise Grade High Speed Internet, Subterranean Parking with Valet Service

POINTS OF INTEREST: Adjacent to World Renowned 3rd Street Promenade and Santa Monica Place for Shopping, Theatres and Dining, Wednesday Farmer's Market, Restaurants, Hotels, Starbucks, Direct Beach Access