

BARRISTER

EXECUTIVE SUITES, INC.

5901 Century

5901 West Century Boulevard, Suite 750
Los Angeles, CA 90045
(310) 338-0031/http://www.barrister-suites.com
800-576-0744

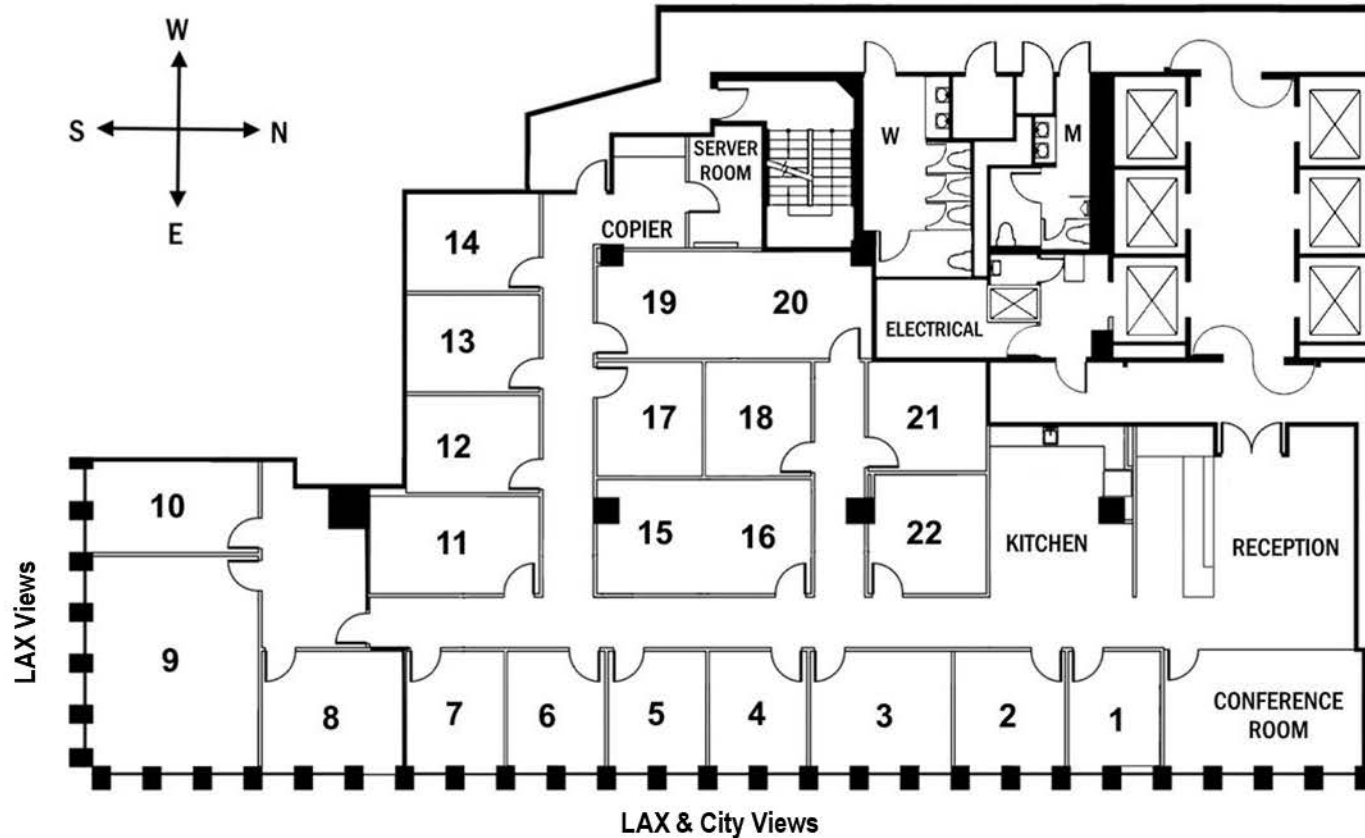

Leasing Manager: Sarah Clemens

Hours of Operation: 8:30 am to 5:00 pm

DIRECTIONS: 405 Fwy, (north or south) exit Century Blvd. west. Or
105 west, exit Sepulveda Blvd. north, turn right on Century Blvd.

PARKING: Reserved: \$265.00
Unreserved: \$165.00

AMENITIES: Executive Club House, Dog Park, Bicycle Sharing Program, Café w/ Outdoor Seating, Airport Shuttle and EV Charging Stations on-site.

POINTS OF INTEREST: Los Angeles International Airport, Banks, Health Clubs, Restaurants, Hotels, Coffee Shops, Metrolink, Airport Courthouse